

NEBRASKA-1W

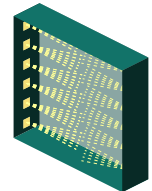

12-30 cm

double-sided
lightboxes



- luminous efficacy 72 lm/W
- for indoor and outdoor use

- 20 pcs in chain

DIMENSIONS

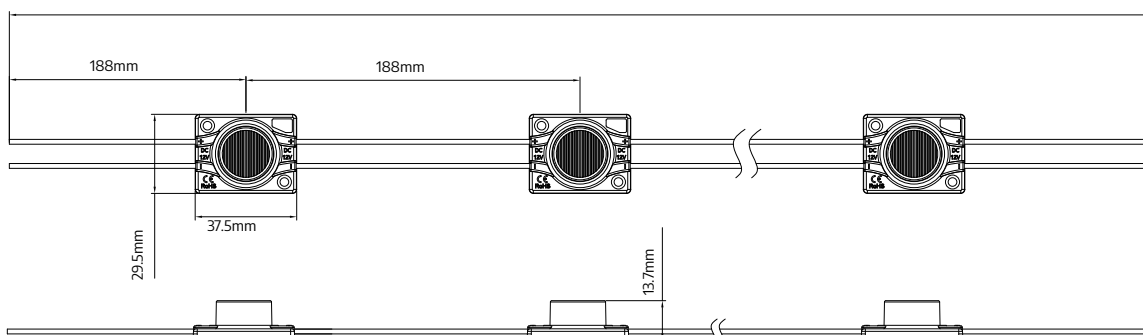

NEBRASKA-1W



TECHNICAL SPECIFICATION

Parameter	Value
Rated voltage	12 V DC
Power consumption per module	2,3 W
Chain power consumption	46 W
Current consumption per module	192 mA
LED diodes	San'an led - 3030
Quantity of LEDs	1
Light color	W - white (7000K)
Flux	165 lm
Flux density	72 lm/W
Color rendering index CRI	≥80 (on request ≥90, ≥95)
Beam characteristic	18 x 40°
Current stabilization	No
Dimming	Yes
Module dimensions (L × W × H)	38 × 29 × 14 mm
Cable length	150 mm
Number of modules in 1 m	5,3
Box weight	18 kg
Montage	Adhesive tape / mounting screw
Lifetime	L70B50 > 50000h
Working temperature	-25°C ... +50°C
IP protection	IP66
Warranty	4 years

NEBRASKA-1W



CONNECTION DIAGRAM

One-side power input



Maximum number of modules 20 pcs

Two-side power input



Maximum number of modules 40 pcs

It is acceptable to connect multiple chains in parallel, as long as the power supply provides sufficient power.

ENERGY LABEL / BEAM ANGLE

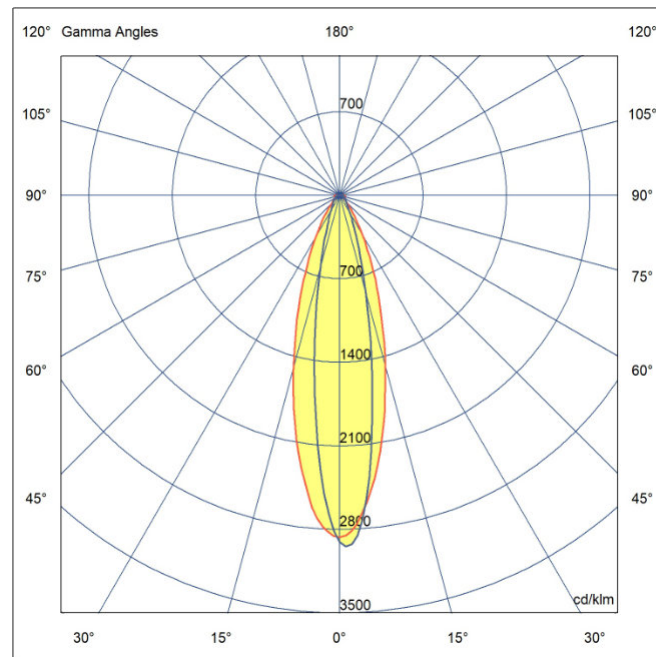
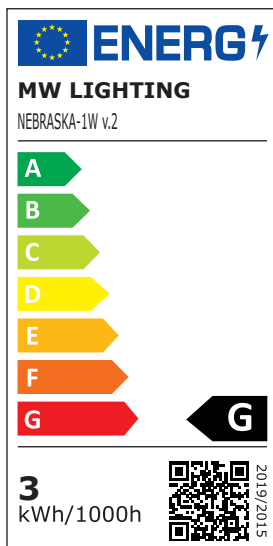

LIGHT COLOR / CCT

Abbreviation	Light color	CCT
WW	warm white	~3000K
NW	neutral white	~4000K
W	white	~7000K
CW	cold white	~10000K

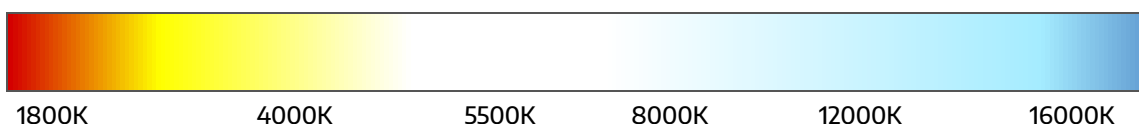

NEBRASKA-1W



PACKING

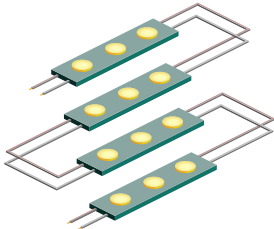

Chain
20 pcs

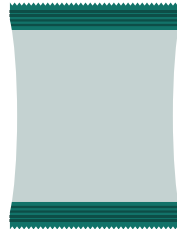

Bag
100 pcs

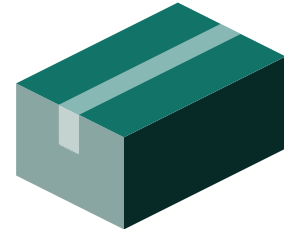

Box
1200 pcs

OTHER NOTES

The 3M tape placed on the device is only used to pre-attach and position the LED modules. Use your own glue or mounting screw to securely and permanently attach the item to the surface.